

Boardwalk

Avonleigh Road

BEDMINSTER, BRISTOL

Avonleigh Road BEDMINSTER

APPROXIMATE FLOOR AREA
43.2 SQM / 465 SQFT



GROUND FLOOR
465 sq.ft. (43.2 sq.m.) approx.

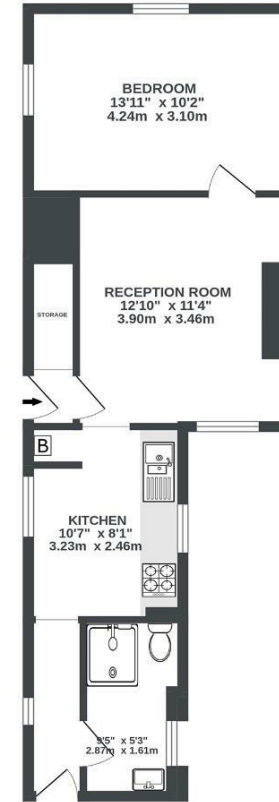

Illustrations are for reference purposes only, measurements are approximate, not to scale.



Boardwalk

Avonleigh Road

BEDMINSTER, BRISTOL

£

£260,000

zzz

1 Bedrooms



BS3 3JA



1 Bathrooms



"I absolutely love my flat in Bedminster. I was drawn to the layout and the perfect size, the lovely bright kitchen with a huge window, and the complete sun trap of a garden that my dog loves sunbathing in. I've also had a lot of success growing tomatoes and courgettes in the raised beds. It is perfectly positioned for a short walk over to North Street - I love Albatross for coffee and pastries, and Spotted Cow and Tobacco Factory for a pint!"

